

Massachusetts Department of Environmental Protection
Bureau of Resource Protection - Wetlands
WPA Form 3 – Notice of Intent
Massachusetts Wetlands Protection Act M.G.L. c. 131, §40

Provided by MassDEP:

MassDEP File Number

Document Transaction Number
Worcester

City/Town

Important:
When filling out forms on the computer, use only the tab key to move your cursor - do not use the return key.



Note:
Before completing this form consult your local Conservation Commission regarding any municipal bylaw or ordinance.

A. General Information

1. Project Location (**Note:** electronic filers will click on button to locate project site):

(Lots 1A & 1B) 10 Apthorp Street
a. Street Address
Worcester
b. City/Town
01606
c. Zip Code
Latitude and Longitude:
42.331177
d. Latitude
-71.789769
e. Longitude
32
f. Assessors Map/Plat Number
024-287-1
g. Parcel /Lot Number

2. Applicant:

a. First Name
JV Realty LLC
b. Last Name
c. Organization
143 Maynard Road
d. Street Address
Framingham
e. City/Town
MA
f. State
01701
g. Zip Code
(617) 594-2616
h. Phone Number
i. Fax Number
vivomoshe@yahoo.com
j. Email Address

3. Property owner (required if different from applicant): Check if more than one owner

Alexander
a. First Name
Smith
b. Last Name
c. Organization
676 Burncoat Street
d. Street Address
Worcester
e. City/Town
MA
f. State
01606
g. Zip Code
(774) 312-1998
h. Phone Number
i. Fax Number
adksmith@wpi.edu
j. Email address

4. Representative (if any):

Glenn
a. First Name
Krevosky
b. Last Name
EBT Environmental Consultants, Inc.
c. Company
601 Main Street
d. Street Address
North Oxford
e. City/Town
MA
f. State
01537
g. Zip Code
(508) 769-3659
h. Phone Number
i. Fax Number
glenn.krevosky@charter.net
j. Email address

5. Total WPA Fee Paid (from NOI Wetland Fee Transmittal Form):

\$1,050.00 (+\$500.00 ordinance)
a. Total Fee Paid
\$512.50
b. State Fee Paid
\$537.50 (+\$500.00 ordinance)
c. City/Town Fee Paid



Massachusetts Department of Environmental Protection
Bureau of Resource Protection - Wetlands

WPA Form 3 – Notice of Intent

Massachusetts Wetlands Protection Act M.G.L. c. 131, §40

| |
|-----------------------------|
| Provided by MassDEP: |
| MassDEP File Number |
| Document Transaction Number |
| Worcester |
| City/Town |

A. General Information (continued)

6. General Project Description:

See attached A.6. General Project Description

7a. Project Type Checklist: (Limited Project Types see Section A. 7b.)

- 1. Single Family Home
- 2. Residential Subdivision
- 3. Commercial/Industrial
- 4. Dock/Pier
- 5. Utilities
- 6. Coastal engineering Structure
- 7. Agriculture (e.g., cranberries, forestry)
- 8. Transportation
- 9. Other

7b. Is any portion of the proposed activity eligible to be treated as a limited project (including Ecological Restoration Limited Project) subject to 310 CMR 10.24 (coastal) or 310 CMR 10.53 (inland)?

- 1. Yes No If yes, describe which limited project applies to this project. (See 310 CMR 10.24 and 10.53 for a complete list and description of limited project types)

2. Limited Project Type

If the proposed activity is eligible to be treated as an Ecological Restoration Limited Project (310 CMR10.24(8), 310 CMR 10.53(4)), complete and attach Appendix A: Ecological Restoration Limited Project Checklist and Signed Certification.

8. Property recorded at the Registry of Deeds for:

Worcester

a. County

62672

c. Book

b. Certificate # (if registered land)

353

d. Page Number

B. Buffer Zone & Resource Area Impacts (temporary & permanent)

- 1. Buffer Zone Only – Check if the project is located only in the Buffer Zone of a Bordering Vegetated Wetland, Inland Bank, or Coastal Resource Area.
- 2. Inland Resource Areas (see 310 CMR 10.54-10.58; if not applicable, go to Section B.3, Coastal Resource Areas).

Check all that apply below. Attach narrative and any supporting documentation describing how the project will meet all performance standards for each of the resource areas altered, including standards requiring consideration of alternative project design or location.

A.6. General Project Description

Site: (Lot 1A & Lot 1B) 10 Aphorp Street, Worcester

Applicant: JV Realty Inc.

The applicant proposes to construct a duplex, split by a property line down the middle with a common wall along the property line. Each unit has its own driveway. The duplex is within the 100' buffer zone to a Red Maple shrub swamp bordering vegetated wetland associated with an intermittent stream. No portion of the structure is within the 30-foot ordinance no structure zone and there is no alteration of the 15' ordinance no disturbance zone. The duplex will be serviced by municipal water and sewer. The Engineer has provided full Stormwater (see Exhibit 9A).

Both streams on the property show as intermittent on the USGS map and, as required as of 12/20/2002 under 310 CMR 10.58, USGS StreamStats was run to prove the streams on the property are intermittent (see attached Exhibit 8A).

Glenn E. Krevosky of EBT Environmental Consultants, Inc. delineated the wetland boundaries on 5/6/2023 with 25 A series wetland flags - utilizing soils, vegetation and indicators of hydrology according to 310 CMR 10.55 (2) (c).

The erosion control measures of staked 9" straw wattles backed by entrenched silt fence, shown on the site plan, shall be placed prior to site work. These measures shall be maintained in good working order throughout the project until all exposed soils are final graded, loamed, seeded and stabilized with well-established soil stabilizing vegetation.



Massachusetts Department of Environmental Protection
Bureau of Resource Protection - Wetlands

WPA Form 3 – Notice of Intent

Massachusetts Wetlands Protection Act M.G.L. c. 131, §40

Provided by MassDEP:

MassDEP File Number

Document Transaction Number

Worcester

City/Town

B. Buffer Zone & Resource Area Impacts (temporary & permanent) (cont'd)

For all projects affecting other Resource Areas, please attach a narrative explaining how the resource area was delineated.

| Resource Area | Size of Proposed Alteration | Proposed Replacement (if any) |
|------------------------------------------------------------------|-----------------------------|-------------------------------|
| a. <input type="checkbox"/> Bank | 1. linear feet | 2. linear feet |
| b. <input type="checkbox"/> Bordering Vegetated Wetland | 1. square feet | 2. square feet |
| c. <input type="checkbox"/> Land Under Waterbodies and Waterways | 1. square feet | 2. square feet |
| | 3. cubic yards dredged | |

| Resource Area | Size of Proposed Alteration | Proposed Replacement (if any) |
|----------------------------------------------------------------|-----------------------------------------------------------------------|-------------------------------|
| d. <input type="checkbox"/> Bordering Land Subject to Flooding | 1. square feet | 2. square feet |
| | 3. cubic feet of flood storage lost | 4. cubic feet replaced |
| e. <input type="checkbox"/> Isolated Land Subject to Flooding | 1. square feet | |
| | 2. cubic feet of flood storage lost | 3. cubic feet replaced |
| f. <input type="checkbox"/> Riverfront Area | 1. Name of Waterway (if available) - specify coastal or inland | |

2. Width of Riverfront Area (check one):

- 25 ft. - Designated Densely Developed Areas only
- 100 ft. - New agricultural projects only
- 200 ft. - All other projects

3. Total area of Riverfront Area on the site of the proposed project: _____ square feet

4. Proposed alteration of the Riverfront Area:

| | | |
|----------------------|-------------------------------|--------------------------------------------|
| a. total square feet | b. square feet within 100 ft. | c. square feet between 100 ft. and 200 ft. |
|----------------------|-------------------------------|--------------------------------------------|

5. Has an alternatives analysis been done and is it attached to this NOI? Yes No

6. Was the lot where the activity is proposed created prior to August 1, 1996? Yes No

3. Coastal Resource Areas: (See 310 CMR 10.25-10.35)

Note: for coastal riverfront areas, please complete **Section B.2.f.** above.



Massachusetts Department of Environmental Protection
Bureau of Resource Protection - Wetlands

WPA Form 3 – Notice of Intent

Massachusetts Wetlands Protection Act M.G.L. c. 131, §40

Provided by MassDEP:

MassDEP File Number

Document Transaction Number

Worcester

City/Town

B. Buffer Zone & Resource Area Impacts (temporary & permanent) (cont'd)

Check all that apply below. Attach narrative and supporting documentation describing how the project will meet all performance standards for each of the resource areas altered, including standards requiring consideration of alternative project design or location.

Online Users:
Include your document transaction number (provided on your receipt page) with all supplementary information you submit to the Department.

| <u>Resource Area</u> | <u>Size of Proposed Alteration</u> | <u>Proposed Replacement (if any)</u> |
|---------------------------------------------------|----------------------------------------------------------------|--------------------------------------|
| a. <input type="checkbox"/> Designated Port Areas | Indicate size under Land Under the Ocean, below | |
| b. <input type="checkbox"/> Land Under the Ocean | _____ | |
| | 1. square feet | |
| | _____ | |
| | 2. cubic yards dredged | |
| c. <input type="checkbox"/> Barrier Beach | Indicate size under Coastal Beaches and/or Coastal Dunes below | |
| d. <input type="checkbox"/> Coastal Beaches | _____ | _____ |
| | 1. square feet | 2. cubic yards beach nourishment |
| e. <input type="checkbox"/> Coastal Dunes | _____ | _____ |
| | 1. square feet | 2. cubic yards dune nourishment |

| | <u>Size of Proposed Alteration</u> | <u>Proposed Replacement (if any)</u> |
|-------------------------------------------------------------------|---------------------------------------------------------------------------------------------------------------------------------|----------------------------------------|
| f. <input type="checkbox"/> Coastal Banks | _____ | |
| | 1. linear feet | |
| g. <input type="checkbox"/> Rocky Intertidal Shores | _____ | |
| | 1. square feet | |
| h. <input type="checkbox"/> Salt Marshes | _____ | _____ |
| | 1. square feet | 2. sq ft restoration, rehab., creation |
| i. <input type="checkbox"/> Land Under Salt Ponds | _____ | |
| | 1. square feet | |
| | _____ | |
| | 2. cubic yards dredged | |
| j. <input type="checkbox"/> Land Containing Shellfish | _____ | |
| | 1. square feet | |
| k. <input type="checkbox"/> Fish Runs | Indicate size under Coastal Banks, inland Bank, Land Under the Ocean, and/or inland Land Under Waterbodies and Waterways, above | |
| | _____ | |
| | 1. cubic yards dredged | |
| l. <input type="checkbox"/> Land Subject to Coastal Storm Flowage | _____ | |
| | 1. square feet | |

4. Restoration/Enhancement
If the project is for the purpose of restoring or enhancing a wetland resource area in addition to the square footage that has been entered in Section B.2.b or B.3.h above, please enter the additional amount here.

a. square feet of BVW

b. square feet of Salt Marsh

5. Project Involves Stream Crossings

a. number of new stream crossings

b. number of replacement stream crossings

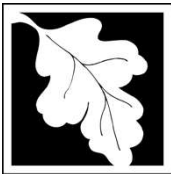

Massachusetts Department of Environmental Protection
Bureau of Resource Protection - Wetlands

WPA Form 3 – Notice of Intent

Massachusetts Wetlands Protection Act M.G.L. c. 131, §40

Provided by MassDEP:

MassDEP File Number

Document Transaction Number

Worcester

City/Town

C. Other Applicable Standards and Requirements

- This is a proposal for an Ecological Restoration Limited Project. Skip Section C and complete Appendix A: Ecological Restoration Limited Project Checklists – Required Actions (310 CMR 10.11).

Streamlined Massachusetts Endangered Species Act/Wetlands Protection Act Review

- Is any portion of the proposed project located in **Estimated Habitat of Rare Wildlife** as indicated on the most recent Estimated Habitat Map of State-Listed Rare Wetland Wildlife published by the Natural Heritage and Endangered Species Program (NHESP)? To view habitat maps, see the *Massachusetts Natural Heritage Atlas* or go to http://maps.massgis.state.ma.us/PRI_EST_HAB/viewer.htm.

- a. Yes No **If yes, include proof of mailing or hand delivery of NOI to:**

**Natural Heritage and Endangered Species Program
Division of Fisheries and Wildlife
1 Rabbit Hill Road
Westborough, MA 01581**

Current
MassMapper _____

If yes, the project is also subject to Massachusetts Endangered Species Act (MESA) review (321 CMR 10.18). To qualify for a streamlined, 30-day, MESA/Wetlands Protection Act review, please complete Section C.1.c, and include requested materials with this Notice of Intent (NOI); *OR* complete Section C.2.f, if applicable. *If MESA supplemental information is not included with the NOI, by completing Section 1 of this form, the NHESP will require a separate MESA filing which may take up to 90 days to review (unless noted exceptions in Section 2 apply, see below).*

- c. Submit Supplemental Information for Endangered Species Review*

- Percentage/acreage of property to be altered:
 - (a) within wetland Resource Area _____ percentage/acreage
 - (b) outside Resource Area _____ percentage/acreage

- Assessor's Map or right-of-way plan of site

- Project plans for entire project site, including wetland resource areas and areas outside of wetlands jurisdiction, showing existing and proposed conditions, existing and proposed tree/vegetation clearing line, and clearly demarcated limits of work **
 - (a) Project description (including description of impacts outside of wetland resource area & buffer zone)
 - (b) Photographs representative of the site

* Some projects **not** in Estimated Habitat may be located in Priority Habitat, and require NHESP review (see <https://www.mass.gov/ma-endangered-species-act-mesa-regulatory-review>).

Priority Habitat includes habitat for state-listed plants and strictly upland species not protected by the Wetlands Protection Act.

** MESA projects may not be segmented (321 CMR 10.16). The applicant must disclose full development plans even if such plans are not required as part of the Notice of Intent process.

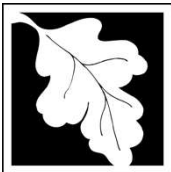

Massachusetts Department of Environmental Protection
Bureau of Resource Protection - Wetlands

WPA Form 3 – Notice of Intent

Massachusetts Wetlands Protection Act M.G.L. c. 131, §40

| | |
|-----------------------------|--|
| Provided by MassDEP: | |
| MassDEP File Number | |
| Document Transaction Number | |
| Worcester | |
| City/Town | |

C. Other Applicable Standards and Requirements (cont'd)

(c) MESA filing fee (fee information available at <https://www.mass.gov/how-to/how-to-file-for-a-mesa-project-review>).

Make check payable to "Commonwealth of Massachusetts - NHESP" and **mail to NHESP** at above address

Projects altering 10 or more acres of land, also submit:

(d) Vegetation cover type map of site

(e) Project plans showing Priority & Estimated Habitat boundaries

(f) OR Check One of the Following

1. Project is exempt from MESA review.
Attach applicant letter indicating which MESA exemption applies. (See 321 CMR 10.14, <https://www.mass.gov/service-details/exemptions-from-review-for-projectsactivities-in-priority-habitat>; the NOI must still be sent to NHESP if the project is within estimated habitat pursuant to 310 CMR 10.37 and 10.59.)

2. Separate MESA review ongoing. a. NHESP Tracking # _____ b. Date submitted to NHESP _____

3. Separate MESA review completed.
Include copy of NHESP "no Take" determination or valid Conservation & Management Permit with approved plan.

3. For coastal projects only, is any portion of the proposed project located below the mean high water line or in a fish run?

a. Not applicable – project is in inland resource area only b. Yes No

If yes, include proof of mailing, hand delivery, or electronic delivery of NOI to either:

South Shore - Cohasset to Rhode Island border, and the Cape & Islands:

North Shore - Hull to New Hampshire border:

Division of Marine Fisheries -
Southeast Marine Fisheries Station
Attn: Environmental Reviewer
836 South Rodney French Blvd.
New Bedford, MA 02744
Email: dmf.envreview-south@mass.gov

Division of Marine Fisheries -
North Shore Office
Attn: Environmental Reviewer
30 Emerson Avenue
Gloucester, MA 01930
Email: dmf.envreview-north@mass.gov

Also if yes, the project may require a Chapter 91 license. For coastal towns in the Northeast Region, please contact MassDEP's Boston Office. For coastal towns in the Southeast Region, please contact MassDEP's Southeast Regional Office.

c. Is this an aquaculture project? d. Yes No

If yes, include a copy of the Division of Marine Fisheries Certification Letter (M.G.L. c. 130, § 57).

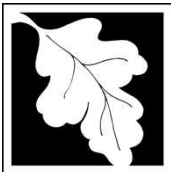

Massachusetts Department of Environmental Protection
Bureau of Resource Protection - Wetlands

WPA Form 3 – Notice of Intent

Massachusetts Wetlands Protection Act M.G.L. c. 131, §40

| |
|-----------------------------|
| Provided by MassDEP: |
| MassDEP File Number |
| Document Transaction Number |
| Worcester |
| City/Town |

Online Users:
Include your document transaction number (provided on your receipt page) with all supplementary information you submit to the Department.

C. Other Applicable Standards and Requirements (cont'd)

4. Is any portion of the proposed project within an Area of Critical Environmental Concern (ACEC)?
 a. Yes No If yes, provide name of ACEC (see instructions to WPA Form 3 or MassDEP Website for ACEC locations). **Note:** electronic filers click on Website.
 b. ACEC
5. Is any portion of the proposed project within an area designated as an Outstanding Resource Water (ORW) as designated in the Massachusetts Surface Water Quality Standards, 314 CMR 4.00?
 a. Yes No
6. Is any portion of the site subject to a Wetlands Restriction Order under the Inland Wetlands Restriction Act (M.G.L. c. 131, § 40A) or the Coastal Wetlands Restriction Act (M.G.L. c. 130, § 105)?
 a. Yes No
7. Is this project subject to provisions of the MassDEP Stormwater Management Standards?
 a. Yes. Attach a copy of the Stormwater Report as required by the Stormwater Management Standards per 310 CMR 10.05(6)(k)-(q) and check if:
 1. Applying for Low Impact Development (LID) site design credits (as described in Stormwater Management Handbook Vol. 2, Chapter 3)
 2. A portion of the site constitutes redevelopment
 3. Proprietary BMPs are included in the Stormwater Management System.
 b. No. Check why the project is exempt:
 1. Single-family house
 2. Emergency road repair
 3. Small Residential Subdivision (less than or equal to 4 single-family houses or less than or equal to 4 units in multi-family housing project) with no discharge to Critical Areas.

D. Additional Information

- This is a proposal for an Ecological Restoration Limited Project. Skip Section D and complete Appendix A: Ecological Restoration Notice of Intent – Minimum Required Documents (310 CMR 10.12).

Applicants must include the following with this Notice of Intent (NOI). See instructions for details.

Online Users: Attach the document transaction number (provided on your receipt page) for any of the following information you submit to the Department.

1. USGS or other map of the area (along with a narrative description, if necessary) containing sufficient information for the Conservation Commission and the Department to locate the site. (Electronic filers may omit this item.)
2. Plans identifying the location of proposed activities (including activities proposed to serve as a Bordering Vegetated Wetland [BVW] replication area or other mitigating measure) relative to the boundaries of each affected resource area.

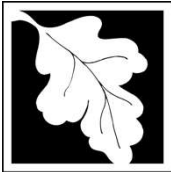

Massachusetts Department of Environmental Protection
Bureau of Resource Protection - Wetlands

WPA Form 3 – Notice of Intent

Massachusetts Wetlands Protection Act M.G.L. c. 131, §40

| |
|-----------------------------|
| Provided by MassDEP: |
| MassDEP File Number |
| Document Transaction Number |
| Worcester |
| City/Town |

D. Additional Information (cont'd)

3. Identify the method for BVW and other resource area boundary delineations (MassDEP BVW Field Data Form(s), Determination of Applicability, Order of Resource Area Delineation, etc.), and attach documentation of the methodology.

4. List the titles and dates for all plans and other materials submitted with this NOI.

Conservation Site Plan

a. Plan Title

Existing Grade Inc.

Edwin H. Gless Jr.

b. Prepared By

c. Signed and Stamped by

2/15/2024

1"=20'

d. Final Revision Date

e. Scale

See attached D.4. Additional Information

f. Additional Plan or Document Title

g. Date

5. If there is more than one property owner, please attach a list of these property owners not listed on this form.

6. Attach proof of mailing for Natural Heritage and Endangered Species Program, if needed.

7. Attach proof of mailing for Massachusetts Division of Marine Fisheries, if needed.

8. Attach NOI Wetland Fee Transmittal Form

9. Attach Stormwater Report, if needed.

E. Fees

1. Fee Exempt: No filing fee shall be assessed for projects of any city, town, county, or district of the Commonwealth, federally recognized Indian tribe housing authority, municipal housing authority, or the Massachusetts Bay Transportation Authority.

Applicants must submit the following information (in addition to pages 1 and 2 of the NOI Wetland Fee Transmittal Form) to confirm fee payment:

2046 (2047 ordinance)

2/26/2024

2. Municipal Check Number

3. Check date

2045

2/26/2024

4. State Check Number

5. Check date

JV Realty LLC

6. Payor name on check: First Name

7. Payor name on check: Last Name

D.4. Additional Information

Project Location: (Lot 1A & 1B) 10 Aphorp Street, Worcester

Applicant: JV Realty Inc.

- 1A. Conservation Site Plan: prepared for JV Realty by Existing Grade Inc., dated 2/15/2024
- 2A. Worcester North USGS Quad, dated 2021
- 3A. Worcester GIS Map, dated 2/19/2024
- 4A. Fee Transmittal Form & Check Copies
- 5A. City of Worcester Abutters' List, dated 2/23/2024
- 6A. Abutters Notification, dated 2/29/2024
- 7A. Affidavit of Service, dated 2/29/2024
- 8A. USGS StreamStats, dated 6/15/2023
- 9A. Storm Water Drainage Report, dated 2/18/2024



Massachusetts Department of Environmental Protection
Bureau of Resource Protection - Wetlands

WPA Form 3 – Notice of Intent

Massachusetts Wetlands Protection Act M.G.L. c. 131, §40

Provided by MassDEP:

MassDEP File Number _____

Document Transaction Number _____

City/Town _____

F. Signatures and Submittal Requirements

I hereby certify under the penalties of perjury that the foregoing Notice of Intent and accompanying plans, documents, and supporting data are true and complete to the best of my knowledge. I understand that the Conservation Commission will place notification of this Notice in a local newspaper at the expense of the applicant in accordance with the wetlands regulations, 310 CMR 10.05(5)(a).

I further certify under penalties of perjury that all abutters were notified of this application, pursuant to the requirements of M.G.L. c. 131, § 40. Notice must be made by Certificate of Mailing or in writing by hand delivery or certified mail (return receipt requested) to all abutters within 100 feet of the property line of the project location.

| | |
|-----------------------------------------------|------------------|
| | |
| 1. Signature of Applicant | 2. Date |
| <i>Alexander Smith</i> | <i>2/26/24</i> |
| 3. Signature of Property Owner (if different) | 4. Date |
| <i>Alexander Smith</i> | <i>2/28/2024</i> |
| 5. Signature of Representative (if any) | 6. Date |
| <i>Michael E. Krevosky</i> | |

For Conservation Commission:

Two copies of the completed Notice of Intent (Form 3), including supporting plans and documents, two copies of the NOI Wetland Fee Transmittal Form, and the city/town fee payment, to the Conservation Commission by certified mail or hand delivery.

For MassDEP:

One copy of the completed Notice of Intent (Form 3), including supporting plans and documents, one copy of the NOI Wetland Fee Transmittal Form, and a **copy** of the state fee payment to the MassDEP Regional Office (see Instructions) by certified mail or hand delivery.

Other:

If the applicant has checked the "yes" box in any part of Section C, Item 3, above, refer to that section and the Instructions for additional submittal requirements.

The original and copies must be sent simultaneously. Failure by the applicant to send copies in a timely manner may result in dismissal of the Notice of Intent.

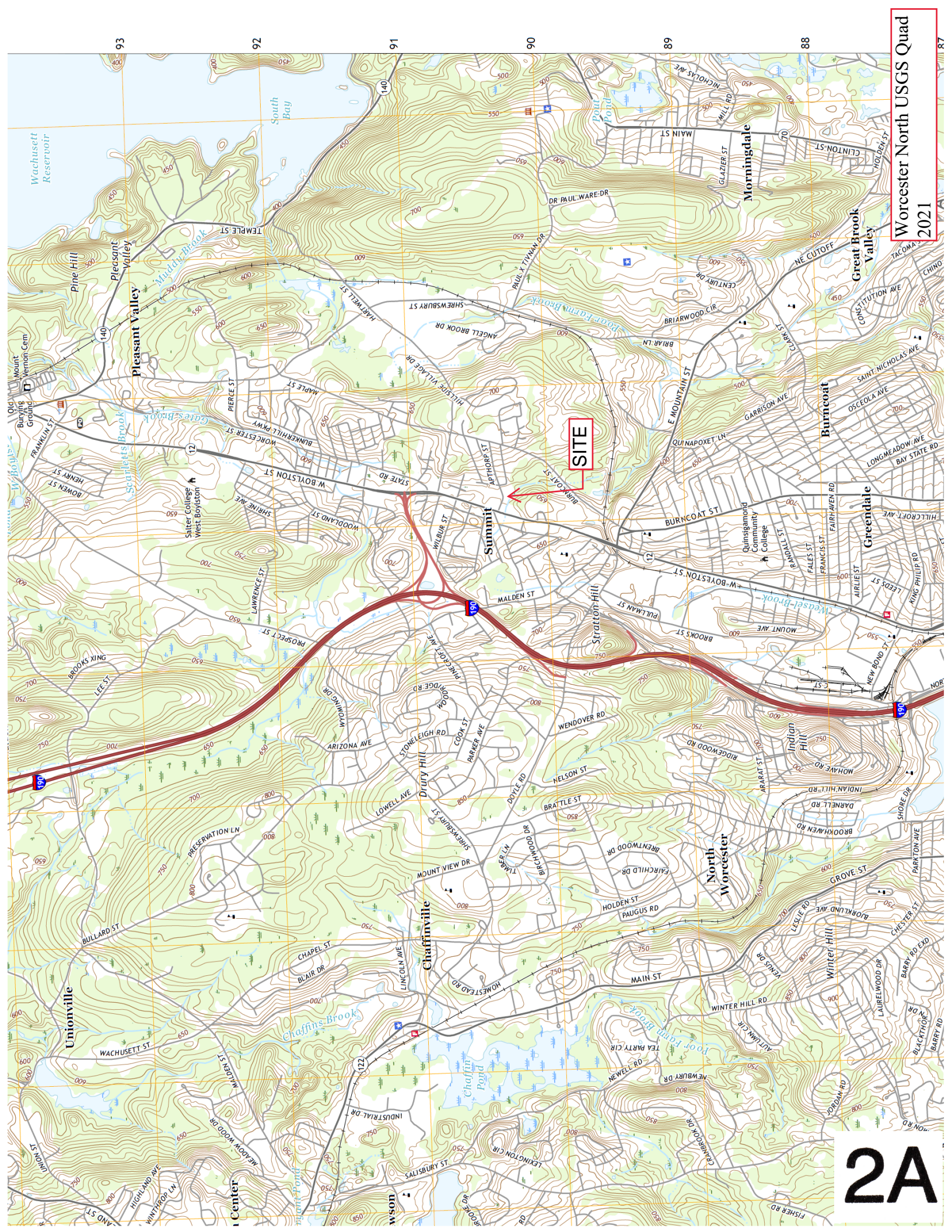

10 Aphthorp Street

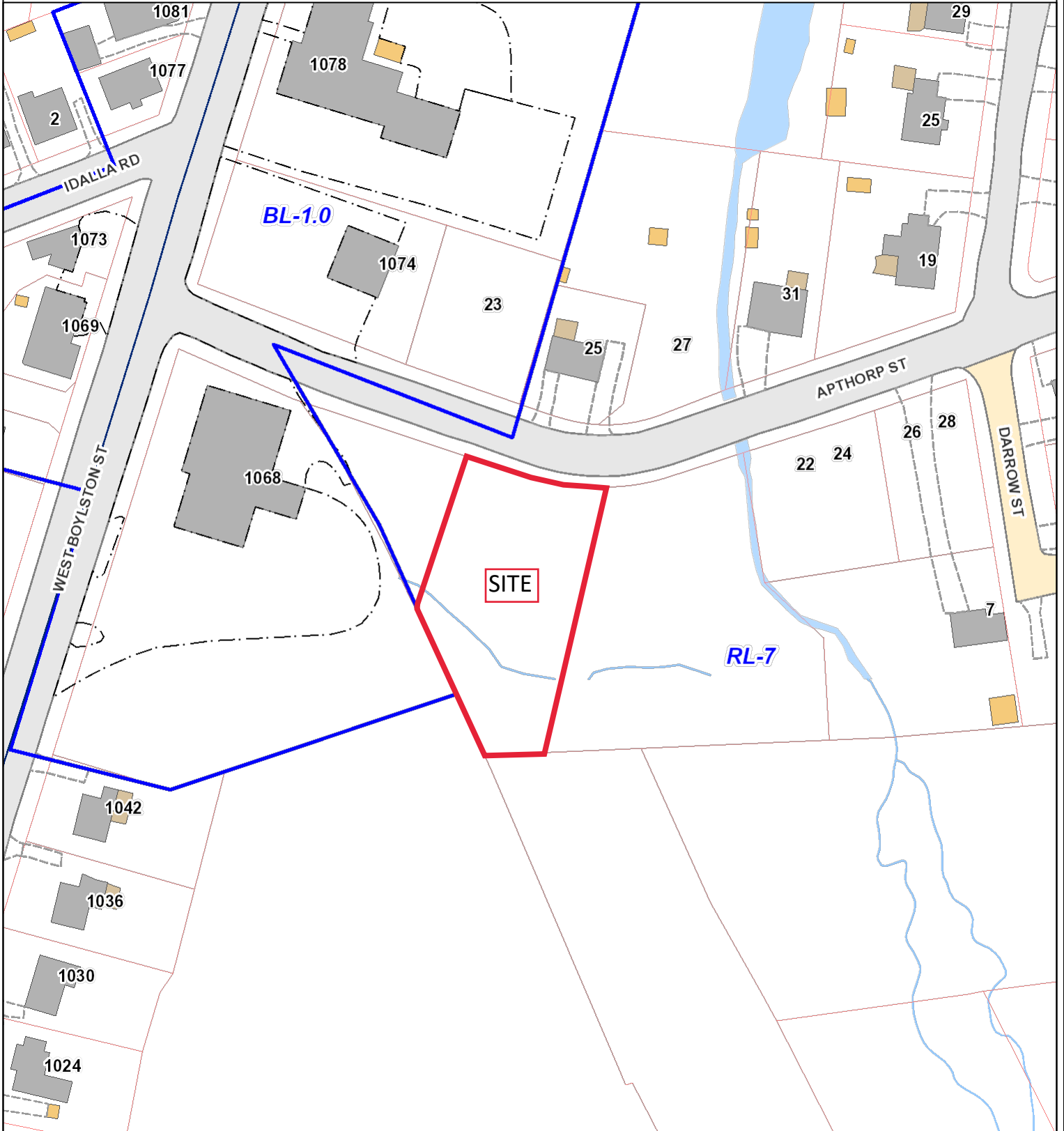

DATA SOURCES:
 Basemap data: City of Worcester, MA Geographic Information System
 Original Data - Digitized at 1:480 scale (Data true resolution: 1 inch = 40 feet).
 Updated Using Spring 2003 Photography at 1 inch = 100 feet
 Further Updates Using City of Worcester Information
 Property Details: City of Worcester, MA Assessing Division

COORDINATE SYSTEM:
 All map data is in the Massachusetts State Plane Coordinate system,
 North American Datum of 1983, Massachusetts Mainland Zone (4151).
 Units are measured in Feet. Vertical Datum NAVD88.

DISCLAIMER:
 Considerable effort has been made to ensure the accuracy, correctness
 and timeliness of data presented; however, this information is only as
 accurate as its sources and may not reflect the most current information.
 This map is a graphical representation of information for tax administration
 purposes only and does not represent a professional survey. The City of
 Worcester assumes no liability for any errors, omissions or inaccuracies
 and makes no warranty, representation or guaranty of any kind as to the
 content or for any decisions made or actions taken or not taken by the
 user based upon any information provided on this map.

- Highways
 - Interstate
 - U.S.
 - State
- Zoning
- Driveways
- Parking Lots
- Parcels
- Edge of Pavement
- Road Surface
 - Paved
 - Unpaved

- Railroad
- Streams
- Ponds
- Buildings
 - Building
 - Deck/Patio
 - Garage/Outbuilding
- Open Space
 - City of Worcester Parks
 - Commonwealth of Massachusetts

1" = 100 ft

February 19, 2024



www.worcester

3A



Massachusetts Department of Environmental Protection
 Bureau of Resource Protection - Wetlands
NOI Wetland Fee Transmittal Form
 Massachusetts Wetlands Protection Act M.G.L. c. 131, §40

Important: When filling out forms on the computer, use only the tab key to move your cursor - do not use the return key.



A. Applicant Information

1. Location of Project:

| | |
|----------------------------------------|-------------------------------------------------|
| (Lots 1A & 1B) 10 Aphthorp Street | Worcester |
| a. Street Address | b. City/Town |
| 2045 (2046 municipal & 2047 ordinance) | \$512.50 (\$537.50 municipal & \$500 ordinance) |
| c. Check number | d. Fee amount |

2. Applicant Mailing Address:

| | | | |
|--------------------|---------------|---------------------|-------------|
| a. First Name | | b. Last Name | |
| JV Realty LLC | | | |
| c. Organization | | | |
| 143 Maynard Road | | | |
| d. Mailing Address | | | |
| Framingham | | MA | 01701 |
| e. City/Town | | f. State | g. Zip Code |
| (617) 594-2616 | | vivomoshe@yahoo.com | |
| h. Phone Number | i. Fax Number | j. Email Address | |

3. Property Owner (if different):

| | | | |
|---------------------|---------------|------------------|-------------|
| Alexander | | Smith | |
| a. First Name | | b. Last Name | |
| c. Organization | | | |
| 636 Burncoat Street | | | |
| d. Mailing Address | | | |
| Worcester | | MA | 01606 |
| e. City/Town | | f. State | g. Zip Code |
| (774) 312-1998 | | adksmith@wpi.edu | |
| h. Phone Number | i. Fax Number | j. Email Address | |

B. Fees

Fee should be calculated using the following process & worksheet. **Please see Instructions before filling out worksheet.**

Step 1/Type of Activity: Describe each type of activity that will occur in wetland resource area and buffer zone.

Step 2/Number of Activities: Identify the number of each type of activity.

Step 3/Individual Activity Fee: Identify each activity fee from the six project categories listed in the instructions.

Step 4/Subtotal Activity Fee: Multiply the number of activities (identified in Step 2) times the fee per category (identified in Step 3) to reach a subtotal fee amount. Note: If any of these activities are in a Riverfront Area in addition to another Resource Area or the Buffer Zone, the fee per activity should be multiplied by 1.5 and then added to the subtotal amount.

Step 5/Total Project Fee: Determine the total project fee by adding the subtotal amounts from Step 4.

Step 6/Fee Payments: To calculate the state share of the fee, divide the total fee in half and subtract \$12.50. To calculate the city/town share of the fee, divide the total fee in half and add \$12.50.

To calculate filing fees, refer to the category fee list and examples in the instructions for filling out WPA Form 3 (Notice of Intent).



Massachusetts Department of Environmental Protection
 Bureau of Resource Protection - Wetlands
NOI Wetland Fee Transmittal Form
 Massachusetts Wetlands Protection Act M.G.L. c. 131, §40

B. Fees (continued)

| Step 1/Type of Activity | Step 2/Number of Activities | Step 3/Individual Activity Fee | Step 4/Subtotal Activity Fee |
|----------------------------------|-----------------------------|--------------------------------|----------------------------------------------------------------|
| Category 3.b. | 1 | \$1,050.00 | \$1,050.00 |
| _____ | _____ | _____ | _____ |
| _____ | _____ | _____ | _____ |
| _____ | _____ | _____ | _____ |
| _____ | _____ | _____ | _____ |
| _____ | _____ | _____ | _____ |
| _____ | _____ | _____ | _____ |
| _____ | _____ | _____ | _____ |
| Step 5/Total Project Fee: | | | \$1,050.00 (+\$500 ordinance) |
| Step 6/Fee Payments: | | | |
| Total Project Fee: | | | \$1,050.00 (+\$500 ord.) |
| State share of filing Fee: | | | a. Total Fee from Step 5 \$512.50 |
| City/Town share of filing Fee: | | | b. 1/2 Total Fee less \$12.50 \$537.50 (+\$500 ord.) |
| | | | c. 1/2 Total Fee plus \$12.50 |

C. Submittal Requirements

- a.) Complete pages 1 and 2 and send with a check or money order for the state share of the fee, payable to the Commonwealth of Massachusetts.

Department of Environmental Protection
 Box 4062
 Boston, MA 02211

- b.) **To the Conservation Commission:** Send the Notice of Intent or Abbreviated Notice of Intent; a **copy** of this form; and the city/town fee payment.

To MassDEP Regional Office (see Instructions): Send a copy of the Notice of Intent or Abbreviated Notice of Intent; a **copy** of this form; and a **copy** of the state fee payment. (E-filers of Notices of Intent may submit these electronically.)



Certified Abutters List

A list of 'parties in interest' shall be attached to the application form and shall include the names and addresses. All such names and addresses shall be obtained from the most recent applicable tax list maintained by the City's Assessing Department. The Assessing Department certifies the list of names and addresses.

Total Count: 11

Parcel Address: 10 APTHORP ST

Assessor's Map-Block-Lot(s): 32-024-287-1

Owner: SMITH, ALEXANDER
676 BURNCOAT ST
WORCESTER, MA 01606

Owner Mailing: _____

Petitioner (if other than owner): GLENN KREVOSKY

Petitioner Mailing Address: 601 MAIN STREET
NORTH OXFORD, MA

Petitioner Phone: 508-769-3659

Planning: _____ Zoning: _____ License Commission: _____ Conservation Commission: X

Historical: _____ Cannabis: _____ Other: _____

| | | | |
|--------------|------------------------------|-----------------------|--------------------|
| 32-020-04+08 | PRODROMITIS PETER | 0037 FOXMEADOW DR | WORCESTER MA 01602 |
| 32-024-01+1A | J + E REALTY DEVELOPMENT LLC | 1068 WEST BOYLSTON ST | WORCESTER MA 01606 |
| 32-020-00012 | HACKER ROGER C + KATHLEEN M | 0025 APTHORP ST | WORCESTER MA 01606 |

| | | | |
|--------------|--------------------------------|-----------------------|--------------------|
| 32-020-09-11 | PRODROMITIS PETER | 0037 FOXMEADOW DR | WORCESTER MA 01602 |
| 32-050-00011 | ROMAN CATHOLIC BISHOP OF WORCE | 0950 WEST BOYLSTON ST | WORCESTER MA 01606 |
| 32-024-0287A | J&E REALTY DEVELOPMENT LLC | 0216 BEAMAN RDT | STERLING MA 01564 |
| 32-056-00003 | NEALE JEAN + ERNEST S JR | 660 BURNCOAT STREET | WORCESTER MA 01606 |
| 32-049-00001 | BUDUO JOHN P + MARIA G + | 0682 BURNCOAT ST | WORCESTER MA 01606 |
| 32-020-012-1 | HACKER RYAN B + KENDRA MAE | 0241 PILGRIM AVE | WORCESTER MA 01604 |
| 32-024-287-1 | SMITH ALEXANDER | 676 BURNCOAT ST | WORCESTER MA 01606 |
| 32-024-00287 | SMITH ALEXANDER | 0676 BURNCAOT ST | WORCESTER MA 01605 |

This is to certify that the above is a list of abutters to Assessor's Map-Block-Lot's 32-024-287-1 as cited above.

Certified by:

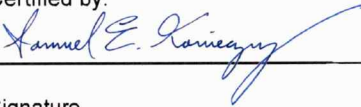

Signature

02/23/2024

Date



The City of
WORCESTER

Assessing Division
Samuel E. Konieczny, MAA, City Assessor
City Hall, 455 Main Street, Worcester, MA 01608
P | 508-799-1098 F | 508-799-1021
assessing@worcesterma.gov

Abutters Map

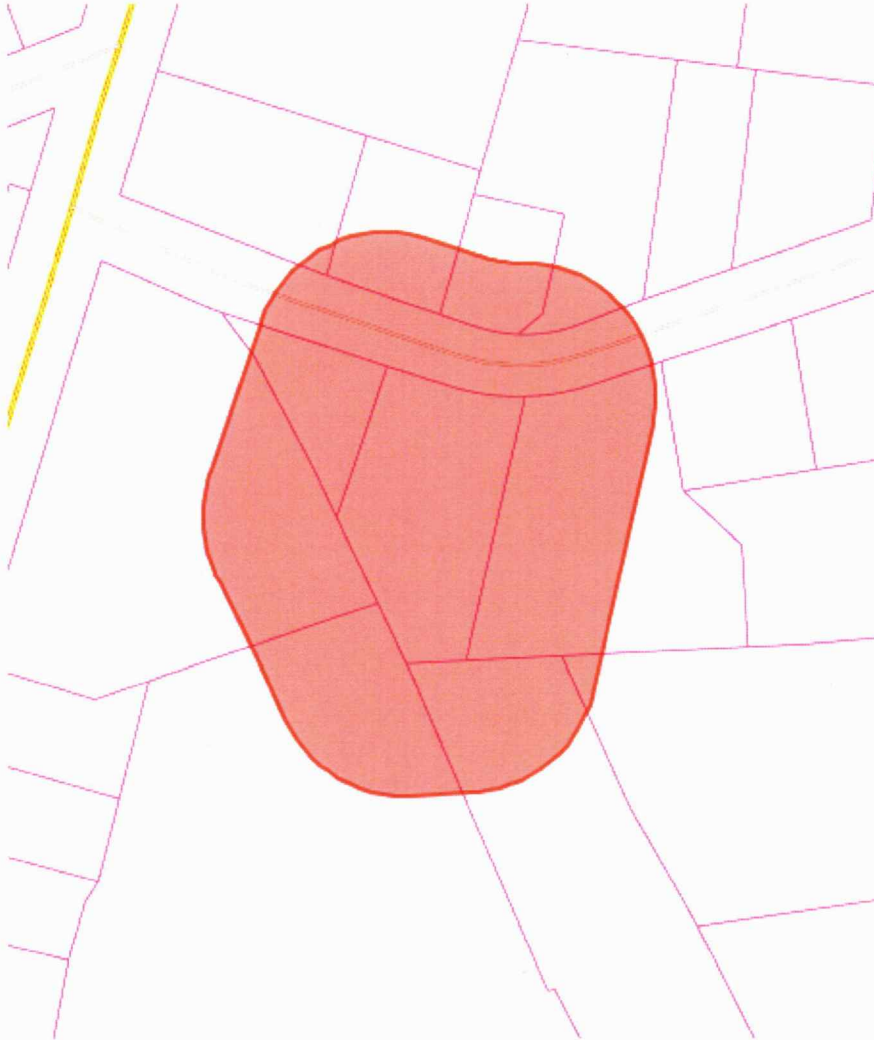

**Notification to Abutters Under the
Massachusetts Wetlands Protection Act**

(This form must be completed and copies sent, by certified mail, certificate of mailing or hand-delivered, to all abutters within 100 feet of the location of the project)

In accordance with the second paragraph of Massachusetts General Laws Chapter 131, Section 40, you are hereby notified of the following:

- A. The name of the Applicant is JV Realty LLC.
- B. The Applicant has filed a Notice of Intent (NOI) with the Worcester Conservation Commission.
- C. The address or location of the lot where the activity is proposed are (Lots 1A & 1B) 10 Aphorp Street, Worcester.
- D. The applicant proposes to construct a duplex, split by a property line down the middle with a common wall along the property line.
- E. Copies of the NOI may be obtained or examined by calling Glenn E. Krevosky of EBT Environmental Consultants, Inc., 601 Main Street, North Oxford, MA 01537 at (508)769-3659 between the hours of 9:00 am and 3:30 pm, Monday through Friday.
- F. This application may be viewed 8:30am-2:00pm at the Division of Planning & Regulatory Services, City Hall, 455 Main Street, Room 404, Worcester, MA. Contact phone number - 508-799-1400 x31440
- G. Agenda for the public hearing, including its date, time, and place, will be posted on the City website (<http://www.worcesterma.gov/city-clerk/agendas-minutes/boards-commissions>) not less than 48 hours prior to the hearing.

PLEASE NOTE:

- 1. Notice of the public hearing, including its date, time and place will be published at least five (5) business days in advance in the Telegram & Gazette.
- 2. Notice of the public hearing including date, time and place will be posted in the Town Hall not less than forty-eight (48) hours in advance.
- 3. You also may contact the Department of Environmental Protection (DEP) Regional Office for more information about this application or the Wetlands Protection Act. To contact the DEP:

CENTRAL REGION: (508) 792-7650

NORTHEAST REGION: (617) 654-6500

WESTERN REGION: (413) 784-1100

SOUTHEAST REGION: (508) 946-2700

2/29/2024

AFFIDAVIT OF SERVICE

**UNDER THE MASSACHUSETTS WETLANDS PROTECTION ACT
AND CITY OF WORCESTER WETLAND PROTECTION ORDINANCE**

(To be submitted to the Massachusetts Department of Environmental Protection & the Conservation Commission when filing a Notice of Intent)

I, Glenn E. Krevosky, hereby certify under the pains and penalties of perjury that on February 29, 2024, I gave notification to abutters within 100 feet of the proposed project in compliance with the second paragraph of the Massachusetts General Laws, Chapter 131, Section 40 and the DEP Guide to Abutter Notification, dated April 8, 1994, in connection with the following matter:

A Notice of Intent (NOI) application filed under the Massachusetts Wetlands Protection Act and The City of Worcester Wetland Protection Ordinance by EBT Environmental Consultants, Inc., 601 Main Street, North Oxford, MA 01537, with the Worcester Conservation Commission on February 28, 2024 for a property located at, (Lots 1A & 1B) 10 Apthorp Street, Worcester.

The form of the notification and the list of the abutters to whom it was given and their addresses are attached to this Affidavit of Service.

Glenn E. Krevosky
Signature

2-29-2024
Date

StreamStats Report

Region ID: MA

Workspace ID: MA20230615163223369000

Clicked Point (Latitude, Longitude): 42.33050, -71.78902

Time: 2023-06-15 12:32:45 -0400

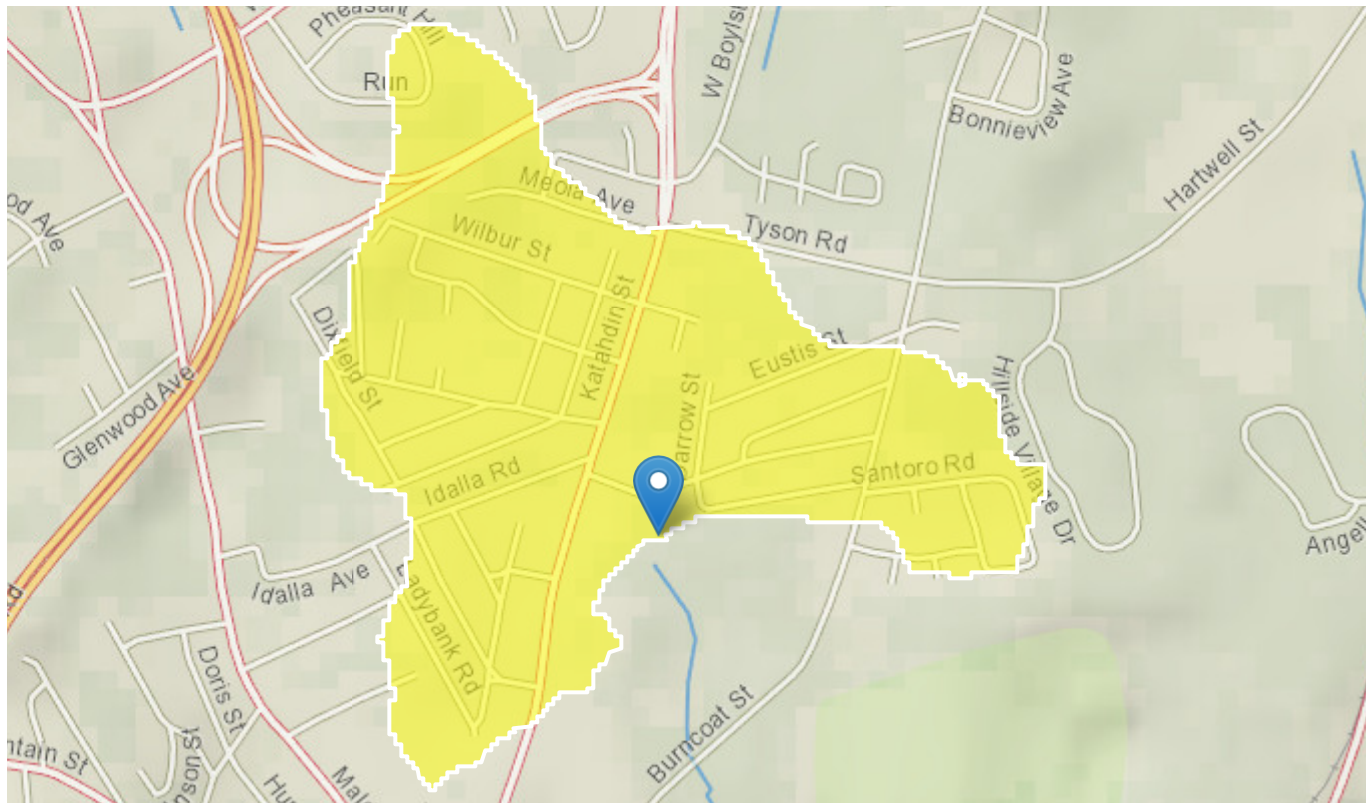

 Collapse All

➤ Basin Characteristics

| Parameter Code | Parameter Description | Value | Unit |
|----------------|----------------------------------------------------|-------|----------------------|
| BSLDEM250 | Mean basin slope computed from 1:250K DEM | 0.847 | percent |
| DRFTPERSTR | Area of stratified drift per unit of stream length | 0 | square mile per mile |
| DRNAREA | Area that drains to a point on a stream | 0.3 | square miles |
| ELEV | Mean Basin Elevation | 656 | feet |

| Parameter Code | Parameter Description | Value | Unit |
|----------------|-----------------------------------------------------------------------|-------|---------------|
| LC06STOR | Percentage of water bodies and wetlands determined from the NLCD 2006 | 0.19 | percent |
| MAREGION | Region of Massachusetts 0 for Eastern 1 for Western | 0 | dimensionless |

➤ Peak-Flow Statistics

Peak-Flow Statistics Parameters [Peak Statewide 2016 5156]

| Parameter Code | Parameter Name | Value | Units | Min Limit | Max Limit |
|----------------|-------------------------------|-------|--------------|-----------|-----------|
| DRNAREA | Drainage Area | 0.3 | square miles | 0.16 | 512 |
| ELEV | Mean Basin Elevation | 656 | feet | 80.6 | 1948 |
| LC06STOR | Percent Storage from NLCD2006 | 0.19 | percent | 0 | 32.3 |

Peak-Flow Statistics Flow Report [Peak Statewide 2016 5156]

PII: Prediction Interval-Lower, Plu: Prediction Interval-Upper, ASEp: Average Standard Error of Prediction, SE: Standard Error (other -- see report)

| Statistic | Value | Unit | PII | Plu | ASEp |
|-----------------------|-------|--------------------|------|------|------|
| 50-percent AEP flood | 21.3 | ft ³ /s | 10.7 | 42.5 | 42.3 |
| 20-percent AEP flood | 36.7 | ft ³ /s | 18.1 | 74.4 | 43.4 |
| 10-percent AEP flood | 49.5 | ft ³ /s | 23.8 | 103 | 44.7 |
| 4-percent AEP flood | 68.6 | ft ³ /s | 31.8 | 148 | 47.1 |
| 2-percent AEP flood | 84.9 | ft ³ /s | 38 | 190 | 49.4 |
| 1-percent AEP flood | 103 | ft ³ /s | 44.6 | 238 | 51.8 |
| 0.5-percent AEP flood | 122 | ft ³ /s | 51.2 | 291 | 54.1 |
| 0.2-percent AEP flood | 151 | ft ³ /s | 60.3 | 378 | 57.6 |

Peak-Flow Statistics Citations

Zarriello, P.J.,2017, Magnitude of flood flows at selected annual exceedance probabilities for streams in Massachusetts: U.S. Geological Survey Scientific Investigations Report 2016–5156, 99 p. (<https://dx.doi.org/10.3133/sir20165156>)

➤ Low-Flow Statistics

Low-Flow Statistics Parameters [Statewide Low Flow WRIR00 4135]

| Parameter Code | Parameter Name | Value | Units | Min Limit | Max Limit |
|----------------|------------------------------------|-------|----------------------|-----------|-----------|
| DRNAREA | Drainage Area | 0.3 | square miles | 1.61 | 149 |
| BSLDEM250 | Mean Basin Slope from 250K DEM | 0.847 | percent | 0.32 | 24.6 |
| DRFTPERSTR | Stratified Drift per Stream Length | 0 | square mile per mile | 0 | 1.29 |
| MAREGION | Massachusetts Region | 0 | dimensionless | 0 | 1 |

Low-Flow Statistics Disclaimers [Statewide Low Flow WRIR00 4135]

One or more of the parameters is outside the suggested range. Estimates were extrapolated with unknown errors.

Low-Flow Statistics Flow Report [Statewide Low Flow WRIR00 4135]

| Statistic | Value | Unit |
|------------------------|---------|--------------------|
| 7 Day 2 Year Low Flow | 0.00588 | ft ³ /s |
| 7 Day 10 Year Low Flow | 0.00119 | ft ³ /s |

Low-Flow Statistics Citations

Ries, K.G., III,2000, Methods for estimating low-flow statistics for Massachusetts streams: U.S. Geological Survey Water Resources Investigations Report 00-4135, 81 p. (<http://pubs.usgs.gov/wri/wri004135/>)

➤ Flow-Duration Statistics

Flow-Duration Statistics Parameters [Statewide Low Flow WRIR00 4135]

| Parameter Code | Parameter Name | Value | Units | Min Limit | Max Limit |
|----------------|------------------------------------|-------|----------------------|-----------|-----------|
| DRNAREA | Drainage Area | 0.3 | square miles | 1.61 | 149 |
| DRFTPERSTR | Stratified Drift per Stream Length | 0 | square mile per mile | 0 | 1.29 |
| MAREGION | Massachusetts Region | 0 | dimensionless | 0 | 1 |
| BSLDEM250 | Mean Basin Slope from 250K DEM | 0.847 | percent | 0.32 | 24.6 |

Flow-Duration Statistics Disclaimers [Statewide Low Flow WRIR00 4135]

One or more of the parameters is outside the suggested range. Estimates were extrapolated with unknown errors.

Flow-Duration Statistics Flow Report [Statewide Low Flow WRIR00 4135]

| Statistic | Value | Unit |
|---------------------|---------|--------------------|
| 50 Percent Duration | 0.28 | ft ³ /s |
| 60 Percent Duration | 0.162 | ft ³ /s |
| 70 Percent Duration | 0.0736 | ft ³ /s |
| 75 Percent Duration | 0.0513 | ft ³ /s |
| 80 Percent Duration | 0.0278 | ft ³ /s |
| 85 Percent Duration | 0.0171 | ft ³ /s |
| 90 Percent Duration | 0.00869 | ft ³ /s |
| 95 Percent Duration | 0.00412 | ft ³ /s |
| 98 Percent Duration | 0.00259 | ft ³ /s |
| 99 Percent Duration | 0.00168 | ft ³ /s |

Flow-Duration Statistics Citations

Ries, K.G., III, 2000, Methods for estimating low-flow statistics for Massachusetts streams: U.S. Geological Survey Water Resources Investigations Report 00-4135, 81 p. (<http://pubs.usgs.gov/wri/wri004135/>)

USGS Data Disclaimer: Unless otherwise stated, all data, metadata and related materials are considered to satisfy the quality standards relative to the purpose for which the data were collected. Although these data and associated metadata have been reviewed for accuracy and completeness and approved for release by the U.S. Geological Survey (USGS), no warranty expressed or implied is made regarding the display or utility of the data for other purposes, nor on all computer systems, nor shall the act of distribution constitute any such warranty.

USGS Software Disclaimer: This software has been approved for release by the U.S. Geological Survey (USGS). Although the software has been subjected to rigorous review, the USGS reserves the right to update the software as needed pursuant to further analysis and review. No warranty, expressed or implied, is made by the USGS or the U.S. Government as to the functionality of the software and related material nor shall the fact of release constitute any such warranty. Furthermore, the software is released on condition that neither the USGS nor the U.S. Government shall be held liable for any damages resulting from its authorized or unauthorized use.

USGS Product Names Disclaimer: Any use of trade, firm, or product names is for descriptive purposes only and does not imply endorsement by the U.S. Government.

Application Version: 4.15.0

StreamStats Services Version: 1.2.22

NSS Services Version: 2.2.1